

PWG series

PWG 79 R 120 (120° redundant)

PWG 79 R 200 (200° redundant)

PWG 79 R 350 (350° redundant)

The angle sensor is developed for rough operation under extreme environmental conditions in mobile applications. Angle ranges of $\pm 60^\circ$, $\pm 100^\circ$ or $\pm 175^\circ$ can be recorded redundantly.

With two independent resistance elements and wipers, the angle sensor complies the safety requirements according to SIL-3. In semi-redundant version to SIL-2.

The main application is the measurement of the steering angle in safety related electronic-hydraulic steering systems direct on the wheel boogie.

Equipped with a conductive plastic resistance element and a long term stabile multiple finger wiper, the angle sensor is suitable for durable operation even under challenging conditions.

A tough full metal housing, continuous stainless steel shaft with double ball bearing and a large distance of the bearing places as well as an interlocking top cover protect the wiper from outer force effects. Hermetic sealing as well as the accuracy and reliability of the absolute analog angle measurement are further special characteristics.

The massive and compact construction allows the direct installation at the axle without additional protective measures. The stabile shaft allows a direct steering via a strong

Special features

- ☐ Two independent measuring systems
- ☐ Extreme tough design
- ☐ Safety Integrity Level up to SIL 3.
- ☐ Absolute potentiometrical measuring system with highest lifetime.
- ☐ Increased corrosion protection by shaft made of stainless steel and anodized housing made out of massive aluminium.
- ☐ Accurate execution with very good linearity and temperature reliability.
- ☐ Absolute splash water proof
- ☐ With connector or PG gland available.
- ☐ Very high life time even at vibration-rich places.
- ☐ High resolution
- ☐ No mechanical turning limit
- ☐

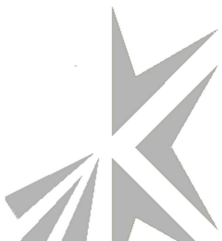

housing - standard

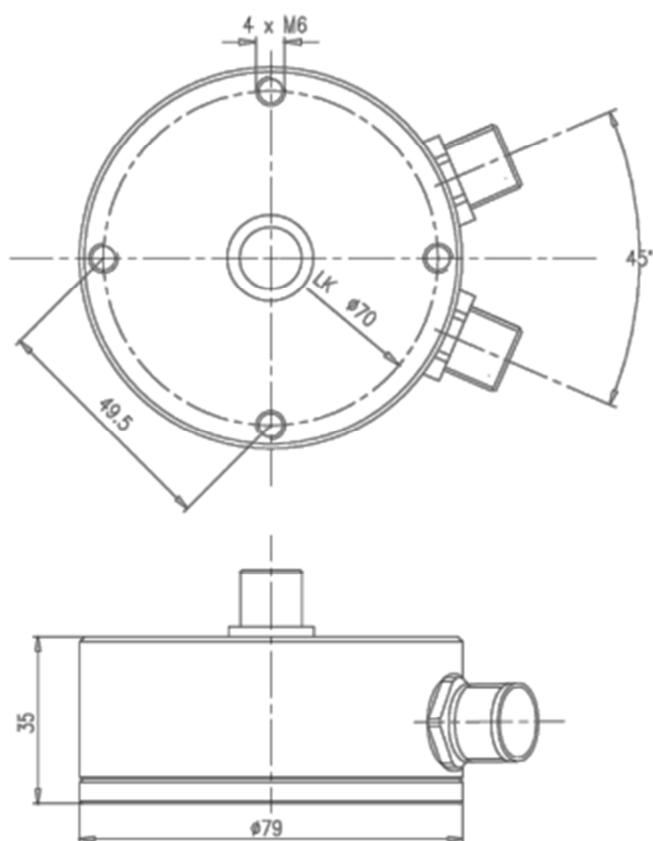

housing - centering flange

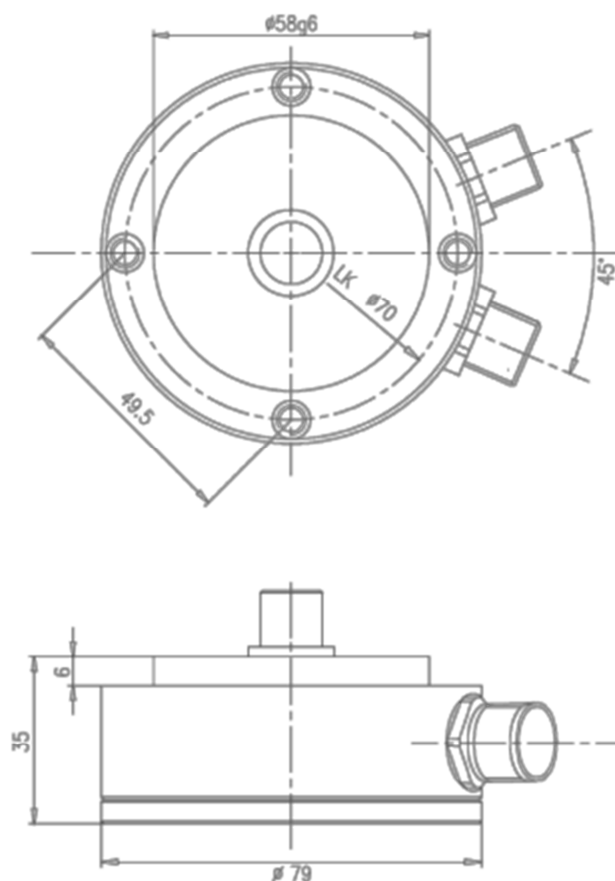

housing - spigot

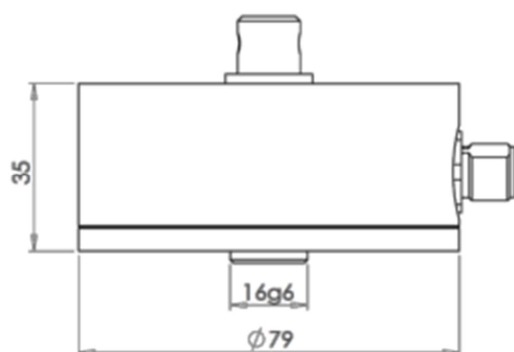

Standard housing









Housing with centering flange

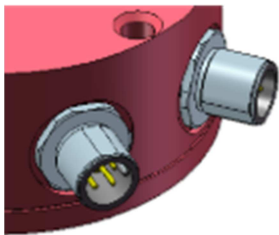
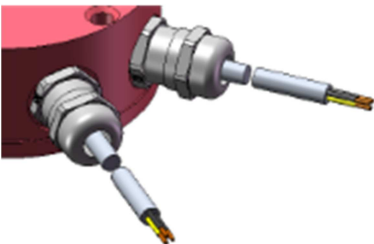

housing with spigot

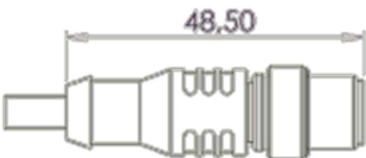
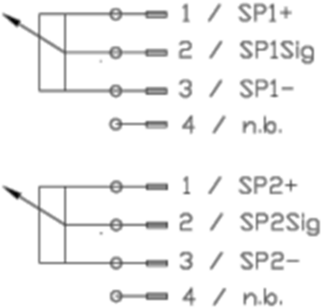
<p>Shaft 01</p>	<p>Shaft 02</p>
<p>Shaft 03</p>	<p>Shaft 04</p>
<p>Shaft 05</p>	<p>Shaft 06</p>
<p>Shaft 07</p>	<p>Shaft 08</p>
<p>Shaft 09</p>	

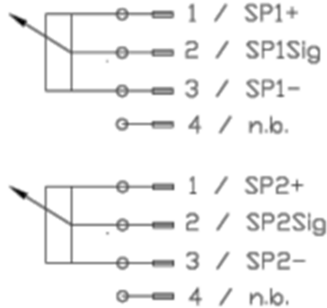
Connector M12	Direct cable outlet	Cable + M12 connector
Line type A, connector 01	Line type C, connector 00	Line type F, connector 01
		
		
 <p> 1 / SP1+ 2 / SP1Sig 3 / SP1- 4 / n.b. </p> <p> 1 / SP2+ 2 / SP2Sig 3 / SP2- 4 / n.b. </p>	 <p> SP1+ sw1 SP1Sig. gn/ge SP1- sw2 </p> <p> SP2+ sw1 SP2Sig. gn/ge SP2- sw2 </p>	 <p> 1 / SP1+ 2 / SP1Sig 3 / SP1- 4 / n.b. </p> <p> 1 / SP2+ 2 / SP2Sig 3 / SP2- 4 / n.b. </p>

Accessory

An extensive program of accessories enables a professional assembling in all imaginable installation circumstances.

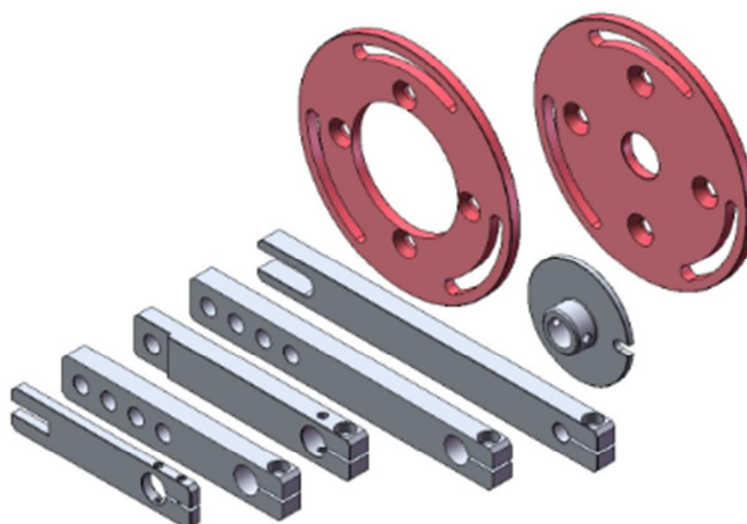

Electrical data			
	PWG 79 R 120	PWG 79 R 200	PWG 79 R 350
Electrical function angle	120° ±2°	200° ±2°	350° ±2°
Nominal resistance	2kΩ	2kΩ	5kΩ
Independent linearity	"0,2 %	"0,15	"0,1
Divergence element 1 to element 2	"0,3 %	"0,25 %	"0,2 %
Nominal resistance tolerance	±15%		
Micro linearity	"0,1 %		
Resolution	practically infinite		
Temperature coefficient	5 ppm/°C (typ.)		
Wiper rated current	10μA		
Max. permissible wiper power	10mA (not for continuous operation)		
Max. power loss at +70°C	3W		
Max. permissible supply voltage	42V		
Isolation resistance	100 MΩ at 500VDC		
Disruptive strength	1000 Vrms, 3000Vrms at POM shaft		

Mechanical data	
Permissible operation and storage temp.	-40°C to +100°C
Protection mode	IP 67 with connector IP 69 with PG gland
Life time	>100 Mio. Revolution
Mechanical angle	360° routable
Max. adjustment speed	50Hz
Oscillation strength (5...2000Hz)	
Impact strength	50G/11ms
Max. axial load	300N
Max. radial load	400N
Max. torque	4Ncm (0,04Nm)
Corrosion resistance shaft	Stainless steel V2A (1.4305)
Corrosion resistance housing	Red anodized aluminum, sea water resistant
Weight	0,5kg

PWG

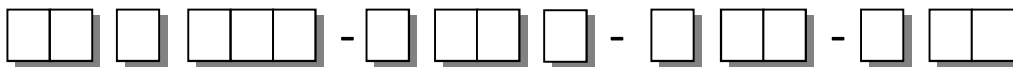
**cable length**
 01 - 1m
02 - 2m
 05 - 5m
 08 - 8m
 10 - 10m
 15 - 15m
cable protection**0 - without cable protection**
 1 - corrugated tube, NW10
 2 - hydraulic hose, DN12
 3 - armored conduit
electrical function angle
 120 - 120°
 200 - 200°
 350 - 350°
centering
0 - without centering
1 - centering flange
 2 - spigot
shaft
01 - Ø13x12 06 - Ø8x18
 02 - Ø13x27 07 - Ø8x23
 03 - Ø13x13 08 - Ø14x23 (flute)
 04 - Ø13x12 09 - Ø6x10
 05 - Ø10x16
shaft material
0 - stainless steel V2A (1.4305)
 1 - POM
connector**00 - without connector**
01 - M12 (pin 1-2-3)
 02 - M12 (pin 1-3-4)
 03 - M12 (pin 1-2-3-4), half red. (SIL2)
 11 - APD DIN 72585 (4-pin), non-redundant
 12 - APD DIN 72585 (4-pin), half red. (SIL2)
 13 - APD DIN 72585 (7-pin), fully red. (SIL3)
 31 - MIL VG 94234 (6pol.), voll redundant (SIL3)
Line type**A - without cable (connector on housing)**
 B - Ölflex FD 810 CY (3x0,5mm²), permanently laid
C - Ölflex FD 855 CP (3x0,5mm²), flexible
 D - Ölflex FD 855 CP (3x0,5mm²), flexible, shield on housing
 E - LiFQ-PUR lengthwise waterproof (6x0,5mm²)
 F - WASS-PUR (4x0,34mm²)
 G - Ployflex FLRY11Y (6x0,5mm²)

 Preferential types are **in bold**, other versions on demand.

Dutch Hydraulic Consultants	Tel.	+31-(0)6-83695868
Achterweg ZZ 8	Mail	info@dhc-hydraulic.nl
3216AB Abbenbroek	Web	www.dhc-hydraulic.nl
Nederland		